



William Guy Gardens, London, E3

BUTLER & STAG



Guide Price £325,000 - £375,000
 Nestled in Bow, E3, this beautifully renovated one-bedroom garden apartment combines contemporary elegance with a cozy, welcoming ambiance. The apartment's semi open-plan layout seamlessly connects the living, dining, and kitchen spaces, creating a sense of openness without sacrificing defined areas. Sunlight floods through Bi-Folding doors and large windows, highlighting the immaculate interiors adorned with modern finishes and subtle tones that complement the spaciousness of the design.



Leasehold

- Private Garden
- Semi Open Plan Concept Living
- One Bedroom
- Beautifully Crafted Kitchen With Curved Shaker Design Cabinetry & Quartz Work Surfaces
- Bi-Folding Doors Leading To The Private Garden

The well-appointed kitchen features shaker cabinetry, high-quality appliances, quartz work surfaces, perfect for cooking and entertaining.

The spacious bedroom offers a peaceful retreat with bespoke fitted wardrobes and direct access to the private rear garden, while the pristine bathroom showcases stylish fittings and a luxurious feel.

One of the apartment's standout features is its large private garden—a rare find in this part of London. This lush, tranquil outdoor space is ideal for relaxing, gardening, or al fresco dining.

Perfectly positioned to take advantage of Bow's charming neighbourhood, with easy access to local shops, green spaces, and excellent transport links, this exceptional garden apartment provides a stylish and serene haven in one of East London's most sought-after locations.





William Guy Gardens

Approx. Gross Internal Area 46 sq. metres (495 sq. feet)

BUTLER & STAG

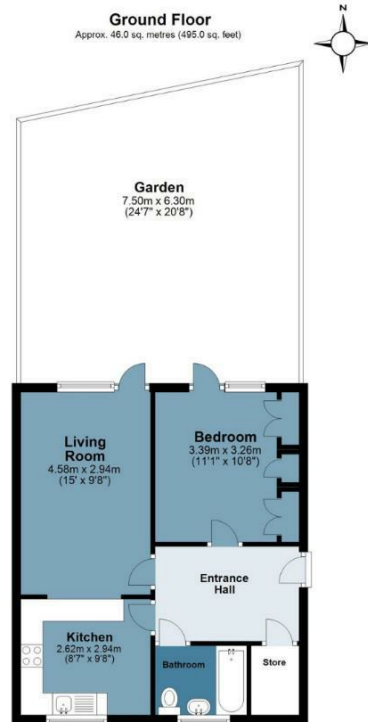

Measurements are approximate and for illustration purposes only. While we do not doubt the accuracy and completeness, we advise you conduct a careful independent assessment of the property to determine monetary value
© @modephotouk www.modephoto.co.uk

BUTLER & STAG

☎ 020 8102 1236

🏠 508 Roman Road, Bow, London, E3 5LU

✉ bow@butlerandstag.com

IMPORTANT NOTICE - These particulars have been prepared in good faith and they are not intended to constitute part of an offer or contract. We have not performed a structural survey on this property and the services, appliances and specific fittings have not been tested. All photographs, measurements, floor plans and distances referred to are given as a guide and should not be relied upon.

www.butlerandstag.uk